

VIEWELL

Model NO: OFD-170

Open Frame Series

17" Open Frame Display

Model NO :OFD-170



Display Specifications

| | |
|---------------------------------|---------------------------------|
| LCD Display | 17" Active Matrix TFT color LCD |
| Active Display Area | 337.920(H) x 270.336(V) mm |
| Resolution | 1280 x 1024 |
| Pixels Pitch | 0.264(per one triad) x 0.264 mm |
| Brightness [cd/m ²] | 250 (Typ) or 800 (optional) |
| Contrast Ration | 1000 : 1(Typ.) |
| Viewing Angle | 170° (H) / 160°(V) |

System

| | |
|----------------|--|
| I/O Connectors | DC power input x 1 , VGA (15 Pin Female D-SUB) x 1 |
| OSD Control | on the Rear Side |

Power Supply

| | |
|-------------------|-----------|
| Power Consumption | 30 (watt) |
| Power Input | DC 12 V |

Mechanical

| | |
|--------------|---|
| Construction | Metal Chassis |
| Mounting | Panel Mount or VESA Mount (100 x 100 Mount) |
| Dimension | 439.4 x 339.4 x 39 mm |
| Net Weight | 4.00 KGS |

Environmental

| | |
|-----------------------|--------------------------|
| Operating Temperature | 0°~50° C (32° ~122° F) |
|-----------------------|--------------------------|

Other Features

| | |
|----------------------|--------------------------------------|
| Optional DVI Input | Yes |
| Optional Touch Panel | Resistive, Capacitive (RS232 or USB) |

Dimension

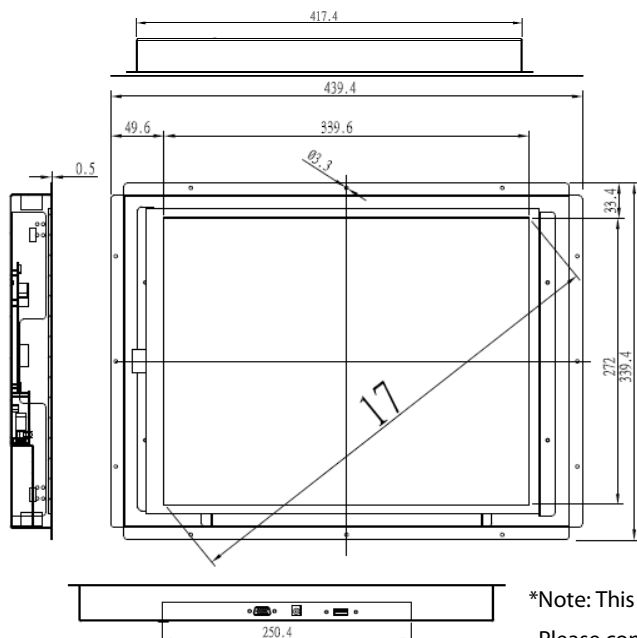

UNIT: mm

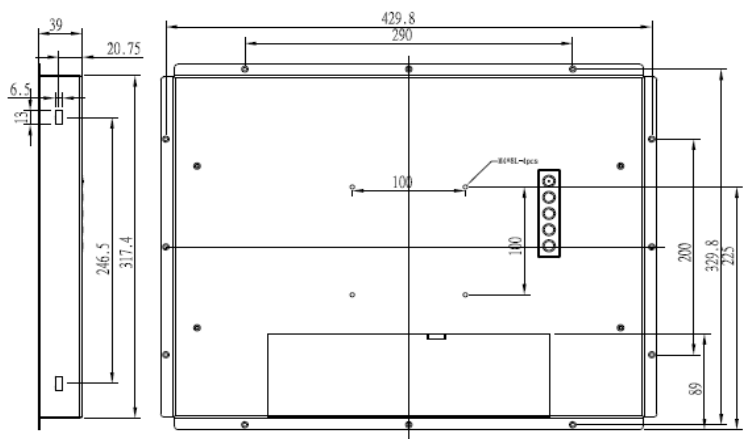

Ordering Options:

- A) Brightness level (250cd/m² or 800cd/m²)
- B) With or without touchscreen
- C) Resistive or Capacitive touchscreen
- D) Touchscreen interface (RS-232 or USB)
- E) With or without DVI option

*Note: This is a simplified drawing and some components are not marked in detail. Please contact us for product detail information.